

**ACCESORIOS SUGERIDOS**

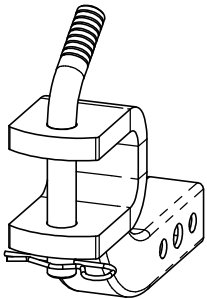

**EAC0615**

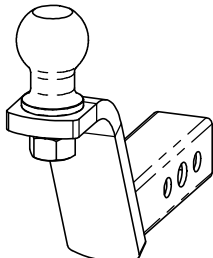

**EAC0612**

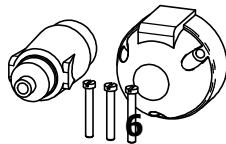

**ASE011**

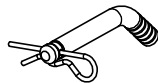

**EAC0607**

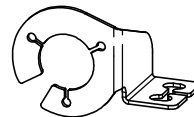

**ASE012**

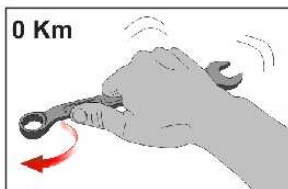

**0 Km**

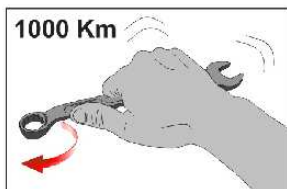

**1000 Km**

VALORES DE APRIETE DE TORNILLOS GRADO 8.8				
	M8	M10	M12	M14
Kg. m	2.5	5.1	8.7	14

Coefficiente de fricción  $\mu_k$  : 0,14

**Instalación:**

- 1). Colocar las placas de anclaje M12 dentro del chasis en ambos lados.
- 2). Presentar el enganche y sujetarlo con los tornillos y arandelas suministradas.

ID	PIEZA	CANT.
1	EVW7493 TRAT.SUP..PINT THERMOCONVERT(NEGRO)	1
2	PLACA ANCLAJE M12 ZINC.	4
3	ARANDELA PLANA Ø12 ZINC.DOR.	4
4	ARANDELA DENTADA Ø12 ZINC.DOR.	4
5	TORNILLO HEX. ZINC.DOR.GR.8.8 M12 P1.75 X 35mm	4
6	TORNILLO HEX. ZINC.DOR.GR.8.8 M12 P1.75 X 80mm	1
7	TORNILLO HEX. ZINC.DOR.GR.8.8 M12 P1.75 X 70mm	1
8	TUERCA C/FRENO HEX. ZINC.DOR.GR.8.8 M12 P1.75	2
9	CALCO ST1 VERDE	1
10	CALCO ATENCIÓN	1